

TOC AMERICAS 2010

RIO DE JANEIRO, BRAZIL

9 – 11 NOVEMBER

UPDATED: 18.08.10

BAND A – US\$6300

A4/ A6/ A14/ A16/ B2/ B14/ B16/
D16/ E18/ F4/ F6

BAND B – US\$7700

A2/ A8/ A12/ B8/ B10/ B18/ B20/
C4/ C6/ C8/ C10/ C12/ C14/ C16/
C18/ D6/ D18/ D20/ E14/ E16/
F8/ F22

BAND C – US\$8250

C2/ C20/ C22/ D4/ D10/ D14/
D22/ E12/ E20/ E22/

BAND D – US\$9995

B6/ D8/

ALL STANDS PLUS US\$450
ADMINISTRATION/ INSURANCE FEE

SHELL SCHEME STANDS INCLUDE:
SHELL SCHEME WALLS
CARPET

FASCIA BOARD WITH COMPANY NAME
ELECTRICAL SOCKET
SPOTLIGHTS
1 TABLE
2 CHAIRS

1 FULL ACCESS DELEGATE PASS PER
STANDHOLDING COMPANY

2 DELEGATE LUNCH PASSES PER
STANDHOLDING COMPANY

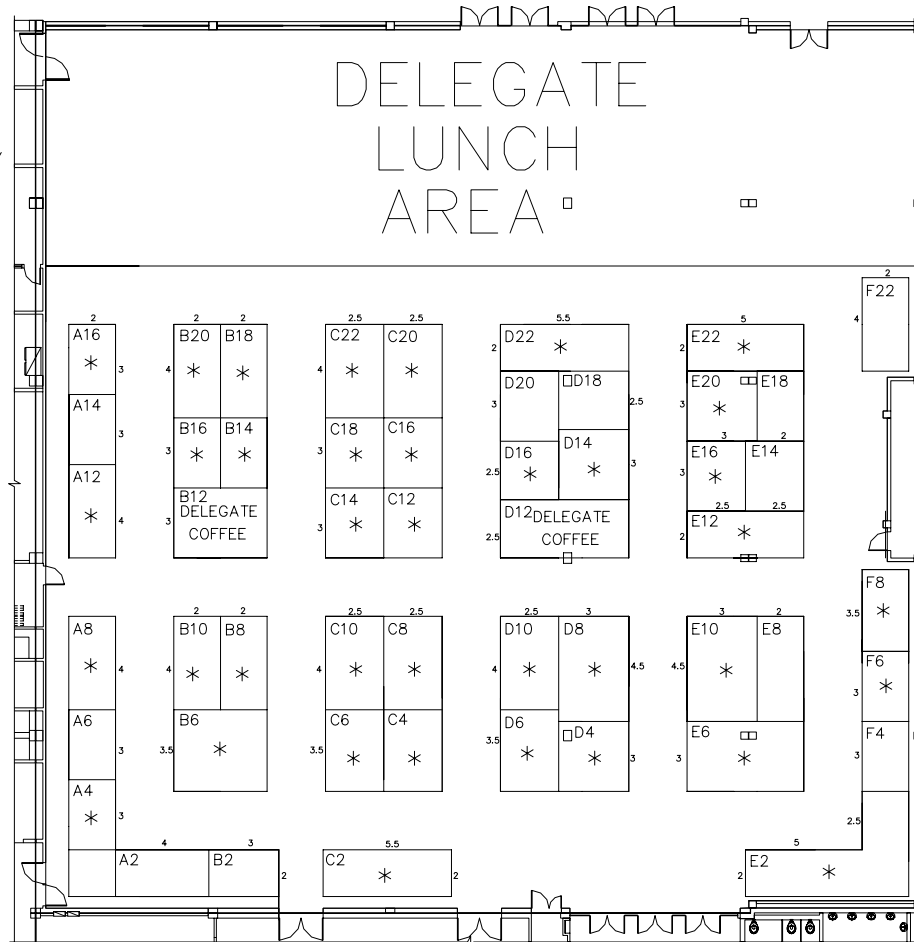

EXHIBITOR LIST

ABB CRANE SYSTEMS	C14
AFCON CONTROL & AUTOMATION	E16
ANACOM	A8
APS TECHNOLOGY GROUP	C4
AUXEMA	E10
BROMMA CONQUIP	E12
CAMCO TECHNOLOGIES	F8
CAVOTEC MSL	A12
CONDUCTIX WAMPFLER	B8
CYBERLOGITEC	B20
DRILLING SYSTEMS	A8
EMERSON CONTROL TECHNIQUES	E20
FORJAS IRIZAR	E22
GAUSSIN MANUGISTIQUE	E6
GOTTWALD PORT TECHNOLOGY	C22
HALCROW	B10
IDENTEC SOLUTIONS	A16
JADE LOGISTICS	D14
KL-NET	B14
KONECRANES	C10
LIEBHERR	D8
LINDE	B6
MAFI	B18
MPRI	F6
NEXANS	C20
PACECO CORP	A4
PORT OF ALGECIRAS AUTHORITY	D22
PORT OF VALPARAISO	C6
PRYSMIAN KABEL & SYSTEME GMBH	C8
RAM SPREADERS	D10
REALTIME BUSINESS SOLUTIONS	C16
SANY PORT MACHINERY	D16
SIBRE	E10
SICK	D6
SIEMENS	D4
SORT + STORE	C18
STEMMANN	C2
SYMEO	E10
TEREX PORT EQUIPMENT	E2
TIMARS	C12
TONGSYS	E10
TOTAL SOFT BANK	B16