

TOC AMERICAS 2010

RIO DE JANEIRO, BRAZIL

9 – 11 NOVEMBER

UPDATED: 24.02.10

DELEGATE LUNCH AREA

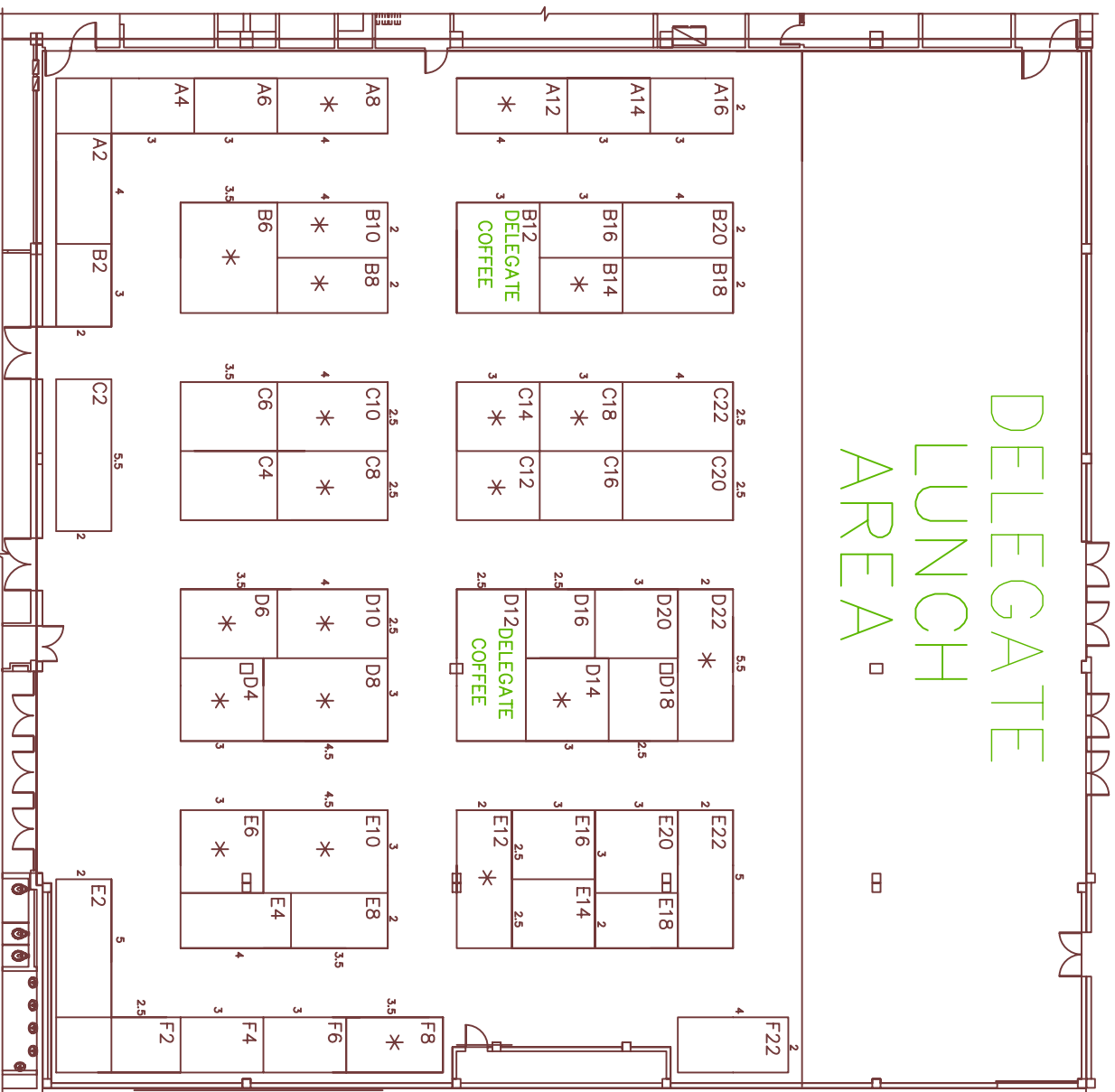

EXHIBITOR LIST

ABB CRANE SYSTEMS	C14
AUXEMA-STEMMANN	E10
BROMMA CONQUIP	E12
CAMCO TECHNOLOGIES	F8
CAVOTEC MSL	A12
CONDUCTIX WAMPFLER	B8
DRILLING SYSTEMS	A8
GOTTWALD PORT TECHNOLOGY	B10
IGUS GMBH	B14
JADE SOFTWARE CORPORATION	D14
KONECRANES	C10
LIEBHERR	D8
LINDE	B6
MICAS	B10
MPRI	D6
PORT OF ALGECIRAS AUTHORITY	D22
PRYSMIAN KABEL & SYSTEME GMBH	C8
RAM SPREADERS	D10
SIEMENS	D4
SORT + STORE	C18
TIMARS	C12
TOTAL SOFT BANK	B8
ZEBRA ENTERPRISE SOLUTIONS	E6